

TECHNICKÝ LIST

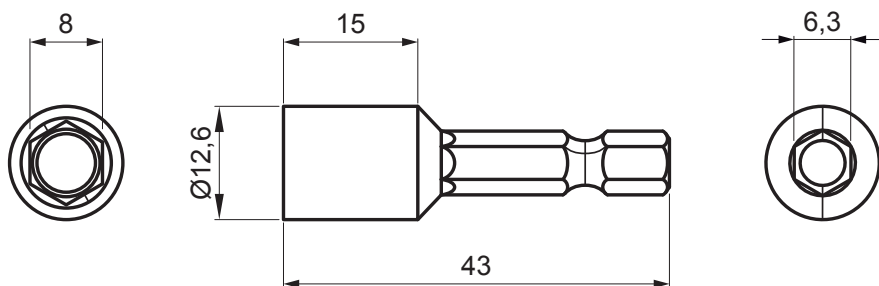



# NÁSTAVEC S MAGNETEM

# KNS-SW8 NAD-MAG



Použití nástavce s magnetem:  
- pro utahování šroubů se 6-hrannou hlavou velikosti 8 mm

 Ocel

|             |                     |          |       |   |   |   |   |
|-------------|---------------------|----------|-------|---|---|---|---|
| INDEX       | ZMĚNA               | DATUM    | PODPS |  |  |  |   |
| ZN. MAT.    |                     |          |       |   |   |   | T.O.  |
| ROZM.-POLOT |                     |          |       |   |   |   |   |
| POM. ZAŘ.   |                     |          |       |   | STN   |   | TR.Č.   |
| VYPR.       | Ing. Kluska M.      |          |       |   | POZN.   |   | Č.POZICE  |
| PRESK.      |                     |          |       |   |   |   |   |
| TECHNOL.    |                     | TECHNOL. |       |   | STARÝ V.  |   | Č.V.  |
| NÁZEV       | Nástavec s magnetem |          |       |   | Počet listů   | KNS-SW8 NAD-MAG   |   |
|             |                     |          |       |   |   | List  |  |

Vytvořeno: 20.01.2026 00:51:55

Technické změny vyhrazeny